

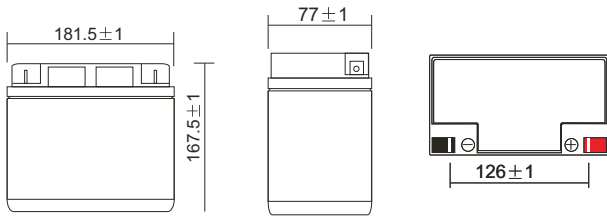

PS-12170 12V 17AH

Dimensions (mm)



Standard Terminal (mm)

T12 Threaded Insert 5mm STUD

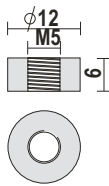

Physical Specification

Nominal Voltage		12V
Nominal Capacity (10HR)		17AH
Dimension	Length	181.5 ± 1mm
	Width	77.0 ± 1mm
	Container Height	167.5 ± 1mm
	Total Height (with Terminal)	167.5 ± 1mm
Weight		Approx 5.7kg
Standard Terminal		T12

Electrical Specification

Rated Capacity	20 hour rate (0.9A)	18AH	Constant-Voltage	Cycle	Initial Charging Current less than 5.4A. Voltage 14.4V~ 15.0V at 25°C (77°F) Temp. Coefficient -30mV/°C
	10 hour rate (1.7A)	17AH			
	5 hour rate (3.2A)	16AH			
	1 hour rate (11.1A)	11.1AH			
Capacity affected by Temperature	40°C (104°F)	103%	Charge	Standby	No limit on Initial Charging Current Voltage 13.5V~13.8V at 25°C(77°F) Temp. Coefficient - 20mV/°C
	25°C (77°F)	100%			
	0°C (32°F)	86%			



Discharging Current & Discharge Duration Time

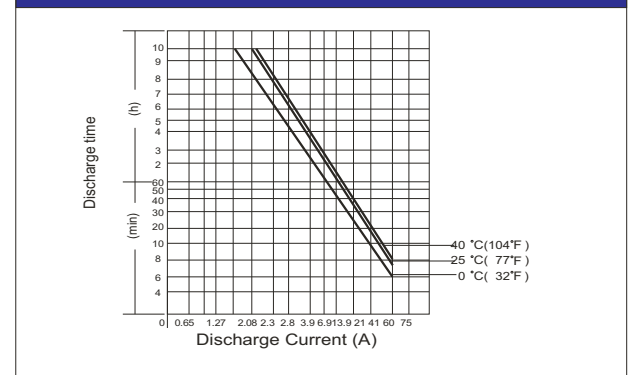

Discharge Characteristics (25°C ,77°C)

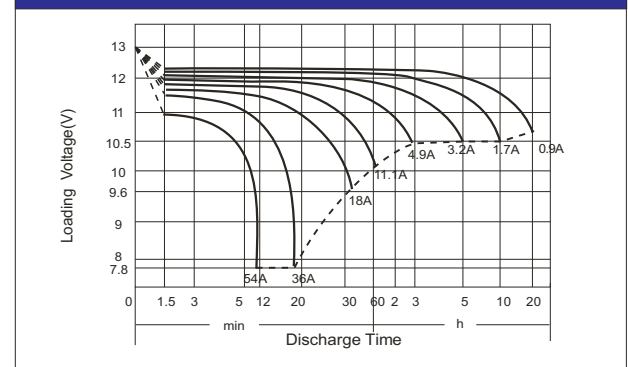

Constant Current Discharge Characteristics Unit: Amperes (25°C, 77°F)

F.V/Time	5MIN	10MIN	15MIN	30MIN	1HR	2HR	3HR	4HR	5HR	8HR	10HR	20HR
1.60V	65.6	44.6	33.0	19.60	11.06	6.32	4.79	3.85	3.15	2.06	1.71	0.891
1.67V	56.6	39.8	29.9	18.10	10.54	6.05	4.56	3.66	3.00	2.02	1.67	0.882
1.70V	54.0	38.0	29.0	17.60	10.33	5.95	4.46	3.60	2.96	2.01	1.66	0.874
1.75V	49.0	34.9	27.2	16.90	10.02	5.72	4.34	3.51	2.92	1.98	1.64	0.859
1.80V	43.5	31.8	24.9	16.20	9.58	5.52	4.26	3.43	2.82	1.95	1.62	0.850
1.85V	32.4	24.9	20.6	13.77	8.55	5.06	3.96	3.22	2.62	1.84	1.53	0.842

Constant Power Discharge Characteristics Unit: Watts (25°C, 77°F)

F.V/Time	5MIN	10MIN	15MIN	30MIN	1HR	2HR	3HR	4HR	5HR	8HR	10HR	20HR
1.60V	652.7	454.6	346.4	213.8	124.8	71.9	54.9	44.3	36.4	24.14	20.15	10.52
1.67V	580.2	417.3	320.8	200.6	120.0	69.3	52.6	42.4	34.8	23.80	19.78	10.45
1.70V	557.2	400.7	312.1	195.0	118.0	68.4	51.5	41.8	34.5	23.64	19.59	10.35
1.75V	520.5	376.2	296.5	188.4	114.8	66.0	50.2	40.8	34.1	23.34	19.43	10.18
1.80V	471.6	347.9	274.8	182.9	110.2	63.9	49.5	40.1	32.9	22.99	19.25	10.09
1.85V	355.1	275.5	230.6	157.5	99.2	58.9	46.2	37.7	30.8	21.74	18.21	10.00



VdS No G103035

